



FUKIN TUNED

USER MANUAL



Table of Contents

- Installation	2
- Registration	3
- Activation	4
- Bluetooth Connection	5
- Login To The App	6
- Modes	7
- Anti-Theft Mode	8
- Installing Remotely Submitted Software	9



Installation

Download Play Store or App Store to connect to Fukin Tuned.

1. Turn over the ignition of your car, then open the Fukin Tuned application.
2. Make sure your mobile device has Bluetooth and GPS turned on.
3. Make sure your mobile device has Bluetooth and GPS turned on.
4. When you open the application, you will see the following screen:
If your email activated before, just continue to Sign-in with your email.
However, if you don't signed up before please click on the button 'Sign-up with email'.

- Unplug Stock Harness
- Connect Unit In-Line to Harness
- Apply Zip-Ties For Mounting
- Activate Your Unit Using The Fukin Tuned App



Registration

5. Enter the requested information and press the "Registration" button:

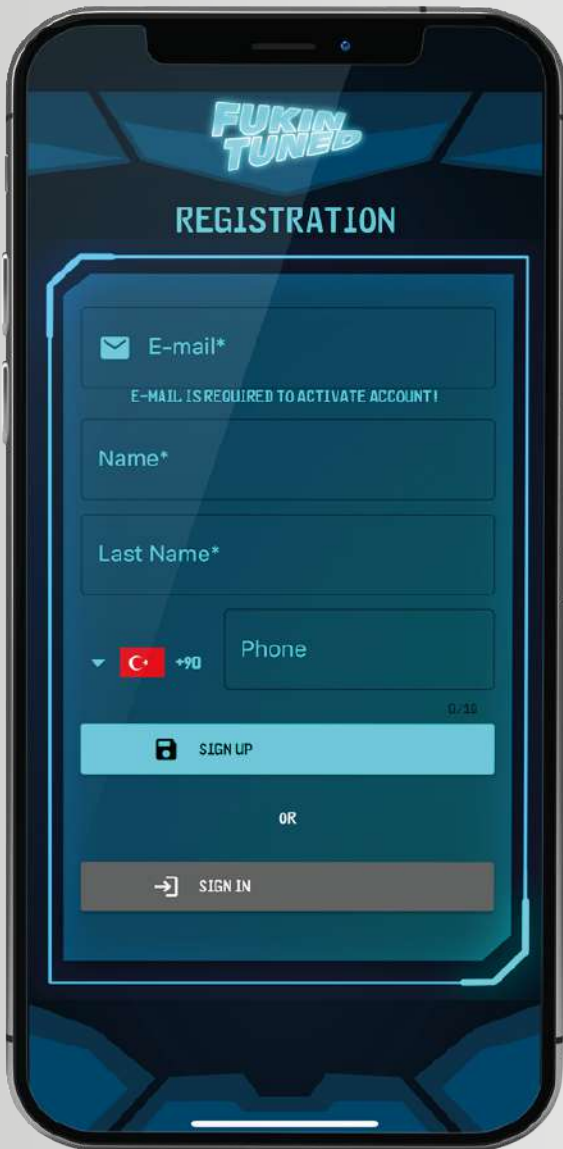

The image shows a smartphone screen with the 'FUKIN TUNED' logo at the top. Below the logo is the word 'REGISTRATION'. The form contains several input fields: 'E-mail*' with a subtext 'E-MAIL IS REQUIRED TO ACTIVATE ACCOUNT!', 'Name*', 'Last Name*', and 'Phone'. The phone field has a dropdown menu showing a Turkish flag and '+90'. Below the phone field is a 'SIGN UP' button. Below the 'SIGN UP' button is an 'OR' label. Below the 'OR' label is a 'SIGN IN' button.

6. An activation email will be sent to the e-mail address you registered:



The image shows a smartphone screen with the 'FUKIN TUNED' logo at the top. Below the logo is the word 'REGISTRATION'. The form contains several input fields: 'E-mail*' with a subtext 'E-MAIL IS REQUIRED TO ACTIVATE ACCOUNT!' and the value 'oguzhan@vitalen.com.tr', 'Name*', and 'Last Name*'. Below the 'Name*' field is a 'CAUTION' dialog box. The dialog box contains the text: 'THE ACTIVATION E-MAIL WILL BE SENT TO THE E-MAIL BELOW. DO YOU CONFIRM?' and 'OGUZHAN@VITALEN.COM.TR'. Below the dialog box are 'YES' and 'NO' buttons. Below the 'YES' and 'NO' buttons is a 'SIGN UP' button. Below the 'SIGN UP' button is an 'OR' label. Below the 'OR' label is a 'SIGN IN' button.

Activation

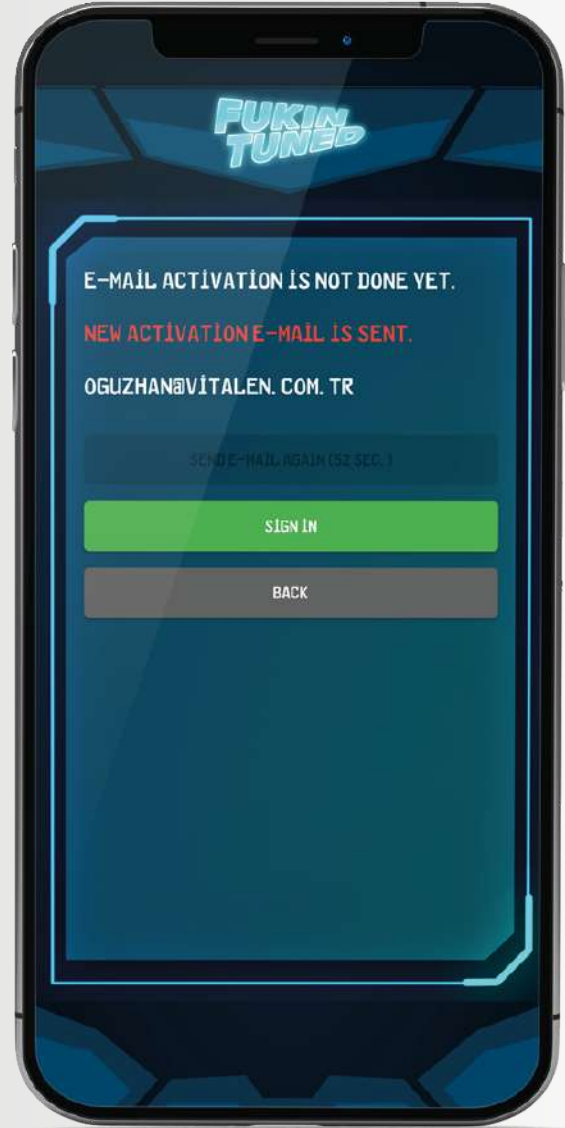

7. Press the "Start Using" button on the activation which was sent to your email address and open the app.

8. In case the activation is not successful, get support from customerservice@fukintuned.com.

Bluetooth Connection



9. Touch to Start



10. Find and select Fukin Tuned that comes up in the Bluetooth scan.



Login To The App



11. Enter the 7-digit serial number located on the side of the device or on the side of the box.
12. Name your device and press the 'Connect' button.

Modes



Fukin Slöw: Touch the Fukin Slöw Mode and choose 'Change'. This mode intentionally reduces the throttle response. It can be used in challenging weather and land conditions.

Fukin Cruise: It makes responses faster in the urban area.

Fukin Fast: Its responses are stronger than Fukin Cruise's, but still suitable for urban use.

Send It: It is the fastest driving mode which is also known as race or long distance mode.

Each mode can be adjusted to 9 different levels.

Anti-Theft Mode

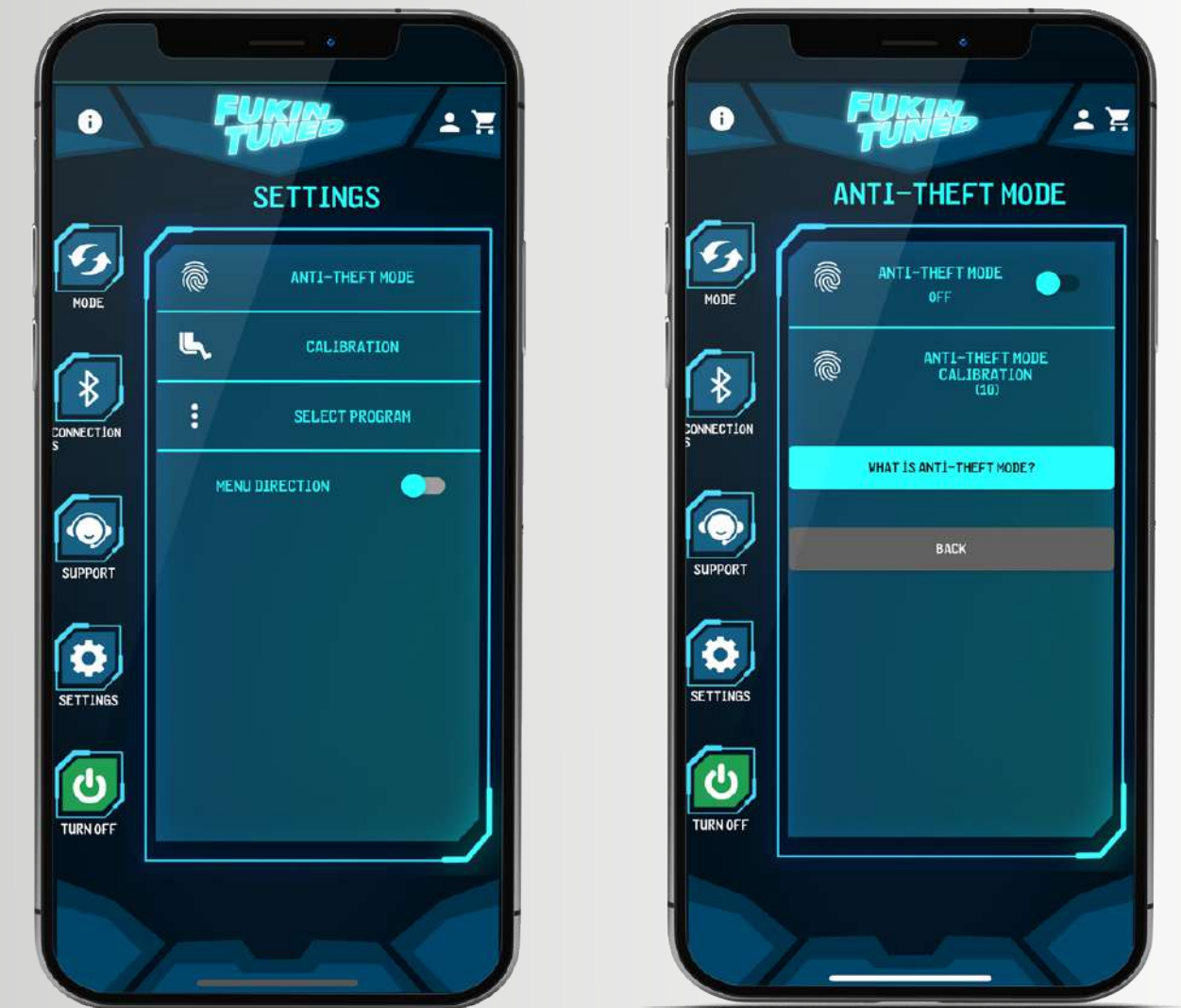

13. Go to settings and press the Anti-Theft Mode.

14. Do the calibration.

-Calibration mode is only done once when you enable Anti-Theft Mode, and you won't need to do it again.

Remote Software Uptade

Essential: It is the program defined by a Fukin Tuned personnel according to your request.

You cannot change the mode without this update.

Standard: It is the program defined by a Fukin Tuned personnel according to your request.

You can install this update at any time.



If you want your Fukin Tuned to change throttle responses, (The process of accelerating or reducing the response), You can request remote software by contacting the technical department.

When you connect to the device from the application, an "Essential Update Available" warning will appear

Press the "Update" button to install the software.